

STAIRS #1A - ELEVATION VIEW

-F	Railing redesign and stairs adjustment	08/04/08			
-C	For Approval	4/28/08			
REV.	DESCRIPTION	DATE	DWN	CHK	
<b>GENERAL NOTES</b>					
MATERIAL: AB=A307; W-SHAPE=A992; CHANNEL, ANGLE, PLATE=A36; HSS AND PIPE =A500 GR-B					
HOLES: 13/16 DIA. UN		CONNS: 3/4" DIA BOLTS		ELECTRODES: E70XX	
SURFACE PREP. AND PAINT:		REF. DRG. STAIRS #1A			
DESCRIPTION: STAIRS # 1A - ELEVATION VIEW					
PROJECT NAME					
LOCATION					
DRAWN BY: e-STEELstudio Ltd. www.e-steelstudio		DRAWING FILE	DATE		
		MODIFY	07/30/2008		
		DRAWN BY	DATE		
			05/08/2008		
		CHKD. BY	DATE		
		JOB No.	DRG. No.	4-ES	

APPROVAL / REVIEW AUTHORITY:  
PLEASE REVIEW THIS DRAWING CAREFULLY.  
IT REPRESENTS OUR INTERPRETATION OF THE INTENT OF THE CONTRACT DOCUMENTS. HOWEVER, THE STEEL FABRICATOR AND THE STRUCTURAL STEEL DETAILER ASSUME NO RESPONSIBILITY FOR THE ACCURACY OF THE INFORMATION SHOWN ON THIS DRAWING. THIS IS THE RESPONSIBILITY OF THE BUYER.  
UNLESS NOTED TO THE CONTRARY ON THIS DRAWING WHEN IT IS RETURNED FROM APPROVAL, IT WILL BE ASSUMED THAT ALL INFORMATION SHOWN HEREIN HAS THE APPROVAL OF THE ORIGINAL AUTHORITY.  
SUBSEQUENT CHANGES TO INFORMATION SHOWN ON THESE DRAWINGS AFTER FIRST SUBMISSION WILL BE CONSIDERED CONTRACT CHANGES.  
Adapted by the National Institute of Steel Detailing, 1977

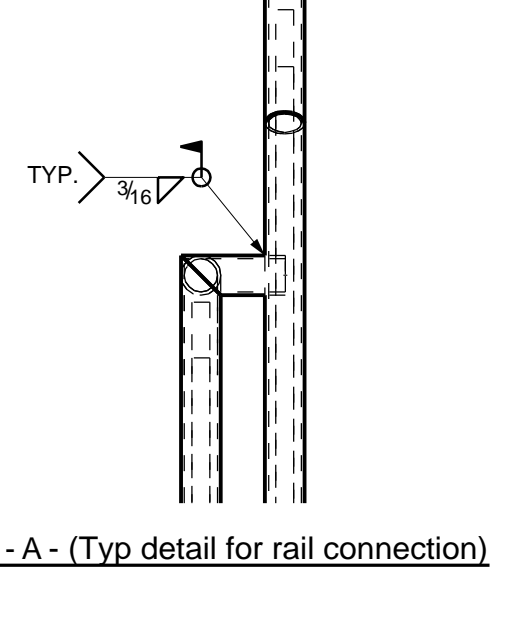

A - A - (Typ detail for rail connection)